

Fiche Technique

Crea 2 LED

☐ Blanc
 ☐ Noir
 ☐ Gris
 ☐ Chroom
 ☐ RAL



Caractéristiques:

Taille de découpe	172 x 322mm
Min. hauteur encastrée	123mm
Poids	2.5kg
IP	20
Classe d'isolation	II
Essai du fil incandescent	850 °C
RoHS	Oui
Sans UV	Oui
Certification	CE

Source de lumière:

Température de couleur	2700K - 3000K - 3500K - 4000K & PW
CRI	Ra 80 & Ra 90
Refroidissement	Actif & Passif
Efficience	92%
SDCM	<3
Durée de vie	50.000h
LB valeur	L80B10

Alimentation:

Driver	Inclus
Voltage	230V
Max. puissance	206W

Options:

Barndoors	Non
Nid d'abeille	Oui
Filtre UV	Oui
LED couleur	Oui
Dimmable	1 DALI & 2 Phase& 3 Casambi
Eclairage de secours	1h
Fixpoint	Non
Lumière alternative	G53 - AR111
Puissance lampe	10W - 15W

Reflectors:

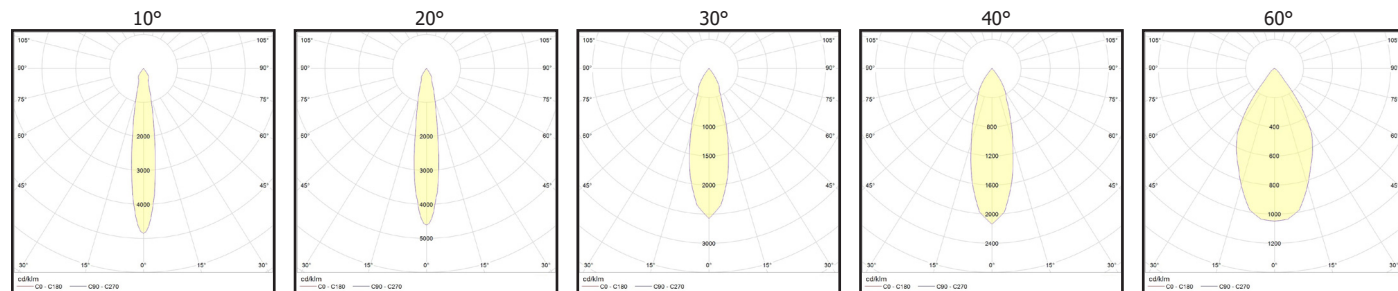
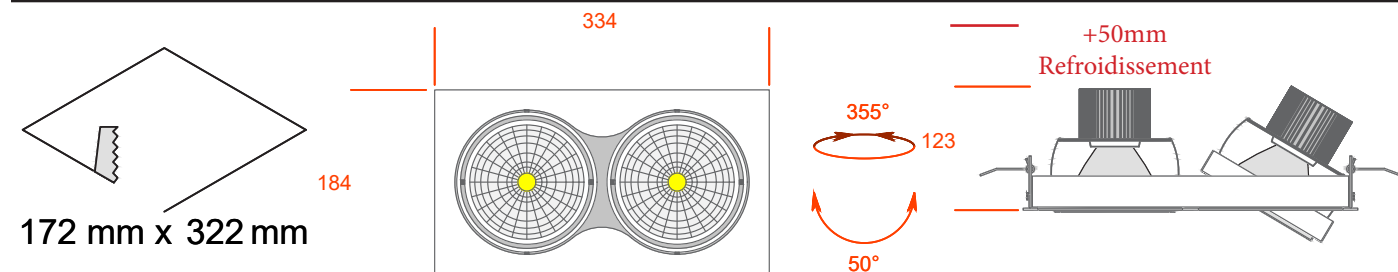
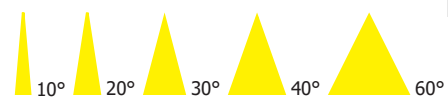

	Ra 80	Ra 90	830	835	927	930	930PW	935PW	940PW
Lumen	Power (W)	Power (W)	Lumen/Watt	Lumen/Watt	Lumen/Watt	Lumen/Watt	Lumen/Watt	Lumen/Watt	Lumen/Watt
1 2 3 700	14.4W	14.2W	96	101	102	106	106	111	114
1 2 3 1500	21.6W	23.2W	159	145	126	130	130	137	141
1 3 2000	26.0W	33.4W	155	158	120	124	124	131	134
1 3 2500	33.4W	41.2W	150	153	117	121	121	127	131
1 3 3000	41.4W	52.0W	145	148	112	116	116	122	125
1 3 3500	49.4W	62.0W	142	144	108	112	112	118	121
1 3 4000	59.6W	75.0W	136	139	103	107	107	113	116
1 3 5000	71.6W	92.4W	144	147	110	115	115	120	124
1 3 6000	92.4W	103.0W	136	139	108	113	113	117	121

Data Sheet

Crea 2 LED

☐ White
 ☐ Black
 ☐ Grey
 ☐ Chrome
 ☐ RAL



Characteristics:

Cut-out size	172 x 322mm
Min. recessed height	123mm
Weight	2.5kg
IP	20
Isolation class	II
Glow wire test	850 °C
RoHS	Yes
UV free	Yes
Certification	CE

Light source:

Colour temperature	2700K - 3000K - 3500K - 4000K & PW
CRI	Ra 80 & Ra 90
Cooling	Actif & Passif
Efficiency	92%
SDCM	<3
Lifetime	50.000h
LB value	L80B10

Power supply:

Driver	Included
Voltage	230V
Max. power	206W

Options:

Barndoors	No
Honeycomb	Yes
UV filter	Yes
Colour LED	Yes
Dimmable	1 DALI & 2 Phase& 3 Casambi
Emergency light	1h
Fixpoint	No
Alternative light source	G53 - AR111
Power lamp	10W - 15W

Reflectors:

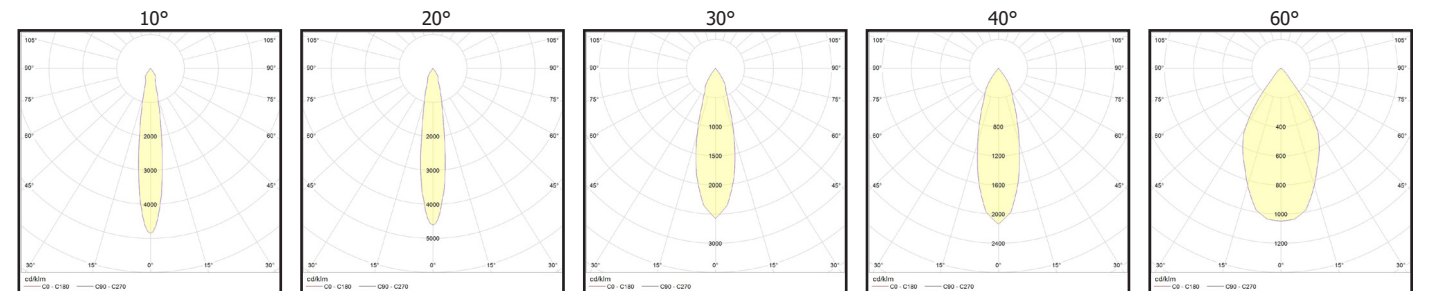
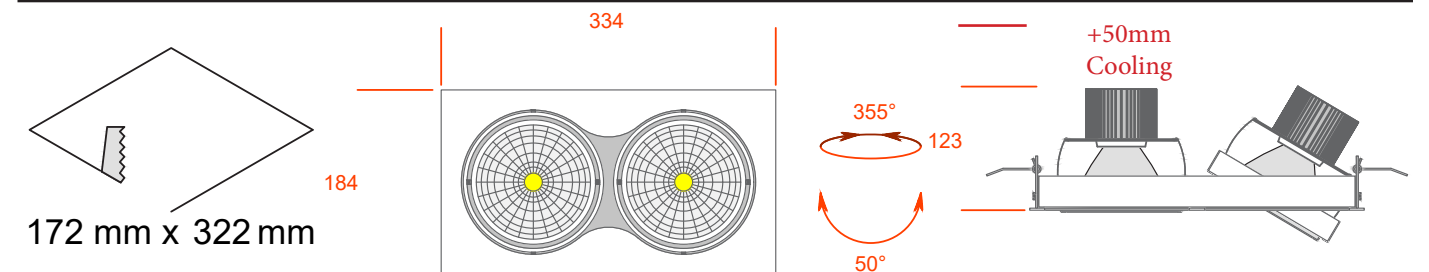
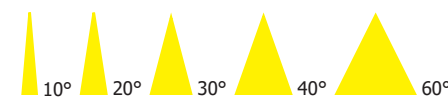

	Ra 80	Ra 90	830	835	927	930	930PW	935PW	940PW
Lumen	Power (W)	Power (W)	Lumen/Watt	Lumen/Watt	Lumen/Watt	Lumen/Watt	Lumen/Watt	Lumen/Watt	Lumen/Watt
1 2 3 700	14.4W	14.2W	96	101	102	106	106	111	114
1 2 3 1500	21.6W	23.2W	159	145	126	130	130	137	141
1 3 2000	26.0W	33.4W	155	158	120	124	124	131	134
1 3 2500	33.4W	41.2W	150	153	117	121	121	127	131
1 3 3000	41.4W	52.0W	145	148	112	116	116	122	125
1 3 3500	49.4W	62.0W	142	144	108	112	112	118	121
1 3 4000	59.6W	75.0W	136	139	103	107	107	113	116
1 3 5000	71.6W	92.4W	144	147	110	115	115	120	124
1 3 6000	92.4W	103.0W	136	139	108	113	113	117	121



Fiche d'Installation Installation Manual

STEP 1

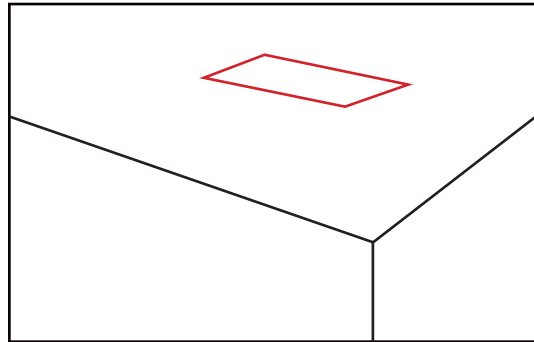

Découpe du plafond a la taille requise

Cut the ceiling to the required size

STEP 3

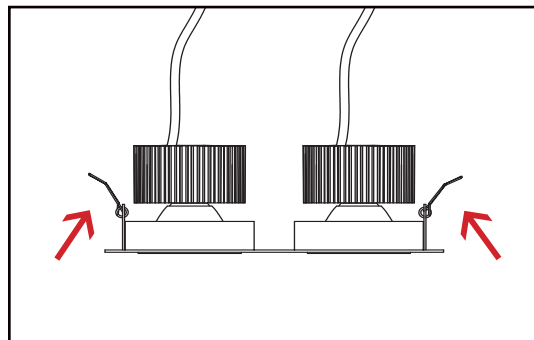

Poussez tous les ressorts vers le haut

Push up all the springs

STEP 5

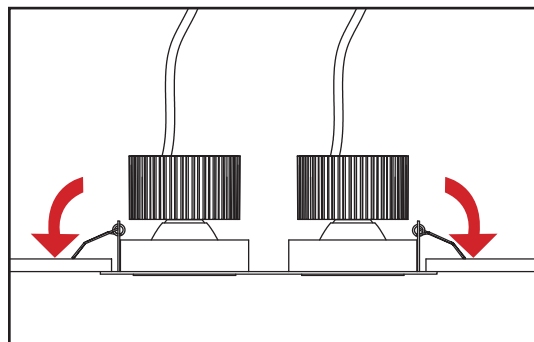

Laisser redescendre les ressort

Let the springs come down

STEP 2

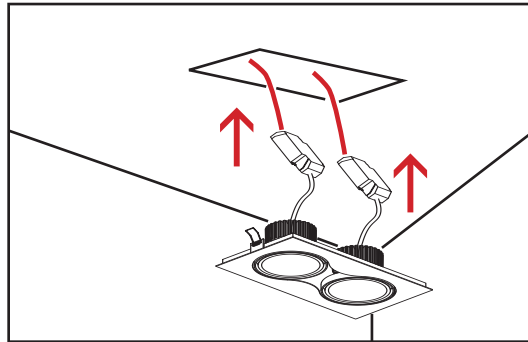

Effectuer le branchement électrique

Make the electrical connection

STEP 4

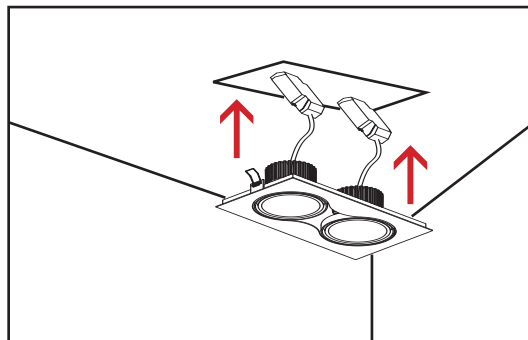

Inserez le spot dans le plafond

Insert the spotlight into the ceiling

STEP 6

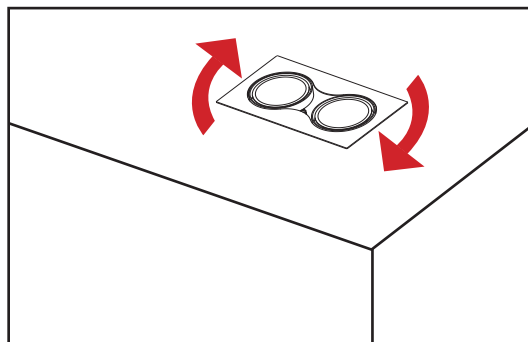

Orientez le spot dans la direction choisie

Point the spotlight in the chosen direction

Crea 2 LED



Crea 2 LED

Nid d'abeille
Honeycomb

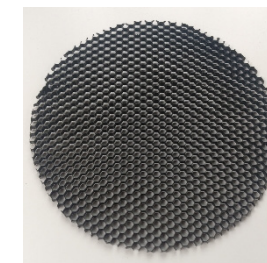

Filtre UV
UV filter



Lampe AR111
AR111 lamp



Eclairage de secours
Emergency light



Technique de Gradation
Dimming Technology



CASAMBI

LED couleur / Colour LED

