

# Fiche Technique

## Zora LED

 Blanc/Noir
  Noir/Noir
  RAL/Noir



### Caractéristiques:

Taille de découpe	N/A
Min. hauteur encastrée	N/A
Poids	1.15kg
IP	20
Classe d'isolation	II
Essai du fil incandescent	850 °C
RoHS	Oui
Sans UV	Oui
Certification	CE

### Source de lumière:

Température de couleur	2700K - 3000K -
	3500K - 4000K & PW
CRI	Ra 80 & Ra 90
Refroidissement	Passif
Efficience	92%
SDCM	<3
Durée de vie	50.000h
LB valeur	L80B10

### Alimentation:

Driver	Inclus
Voltage	230V
Max. puissance	37.5W

### Options:

Barndoors	Non
Nid d'abeille	Oui
Filtre UV	Oui
LED couleur	Oui
Dimmable	1 DALI & 2 Phase & 3 Casambi
Eclairage de secours	Non
Fixpoint	Non

### Reflectors:

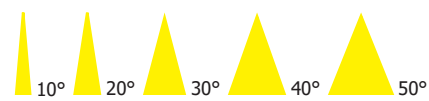

**Projection**.eu  
CREATIVE SOLUTIONS IN SHOP LIGHTING

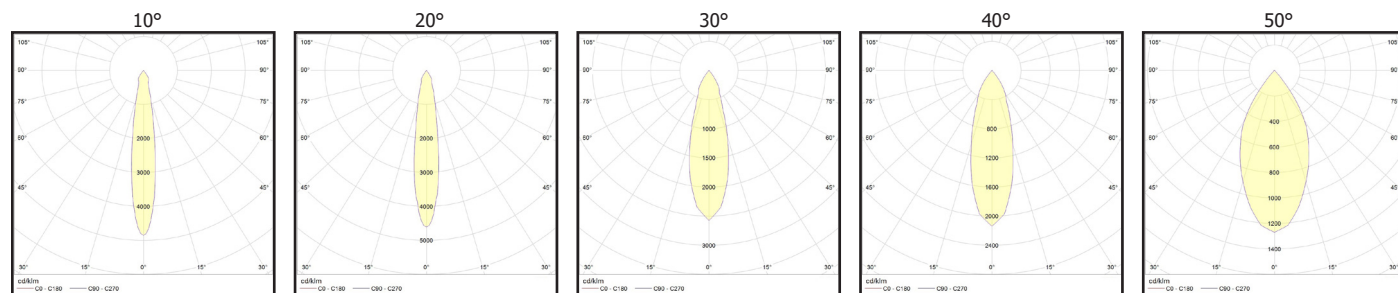
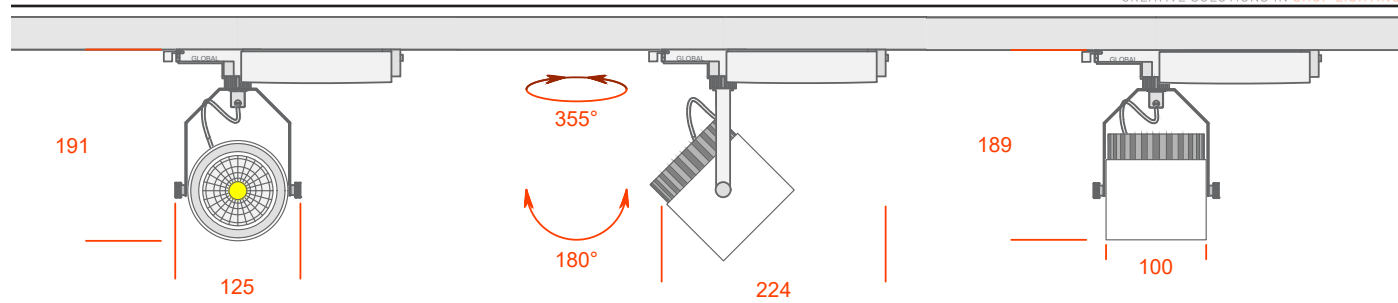

	Ra 80	Ra 90	830	835	927	930	930PW	935PW	940PW
Lumen	Power (W)	Power (W)	Lumen/Watt	Lumen/Watt	Lumen/Watt	Lumen/Watt	Lumen/Watt	Lumen/Watt	Lumen/Watt
1 2 3 700	7.2W	7.1W	96	101	102	106	106	111	114
1 2 3 1500	10.8W	11.6W	159	145	126	130	130	137	141
1 3 2000	13.0W	16.7W	155	158	120	124	124	131	134
1 3 2500	16.7W	20.6W	150	153	117	121	121	127	131
1 3 3000	20.7W	26.0W	145	148	112	116	116	122	125
1 3 3500	24.7W	31.0W	142	144	108	112	112	118	121
1 3 4000	29.8W	37.5W	136	139	103	107	107	113	116
1 3 5000	35.8W	-	144	147	-	-	-	-	-
6000	-	-	-	-	-	-	-	-	-

# Data Sheet

## Zora LED

 White/Black
  Black/Black
  RAL/Black



### Characteristics:

Cut-out size	N/A
Min. recessed height	N/A
Weight	1.15kg
IP	20
Isolation class	II
Glow wire test	850 °C
RoHS	Yes
UV free	Yes
Certification	CE

### Light source:

Colour temperature	2700K - 3000K -
	3500K - 4000K & PW
CRI	Ra 80 & Ra 90
Cooling	Passif
Efficiency	92%
SDCM	<3
Lifetime	50.000h
LB value	L80B10

### Power supply:

Driver	Included
Voltage	230V
Max. power	37.5W

### Reflectors:

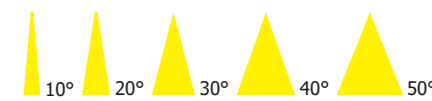

**Projection**.eu  
CREATIVE SOLUTIONS IN SHOP LIGHTING

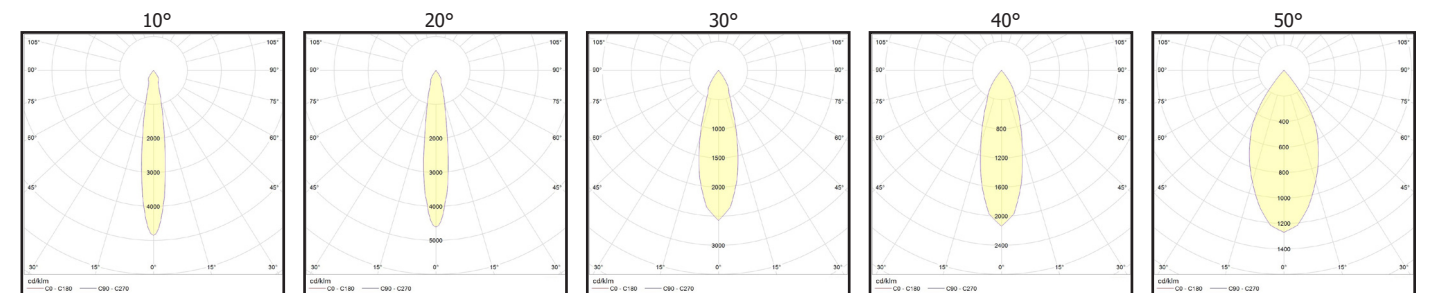
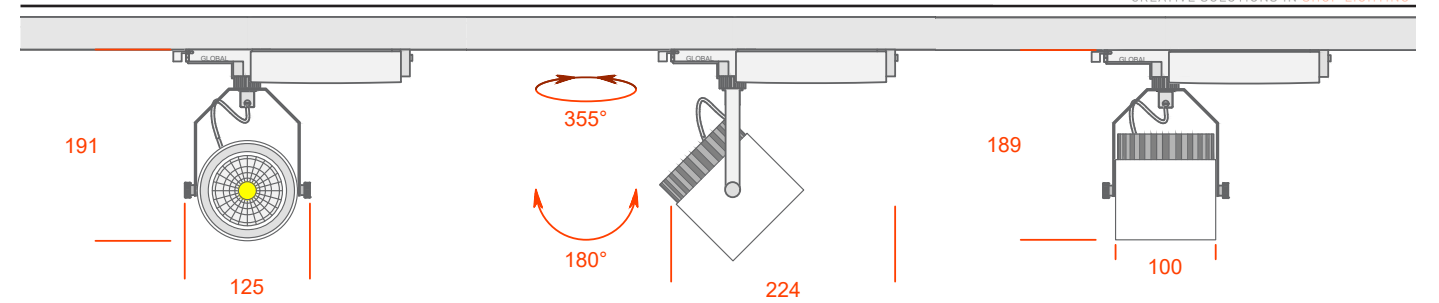

	Ra 80	Ra 90	830	835	927	930	930PW	935PW	940PW
Lumen	Power (W)	Power (W)	Lumen/Watt	Lumen/Watt	Lumen/Watt	Lumen/Watt	Lumen/Watt	Lumen/Watt	Lumen/Watt
1 2 3 700	7.2W	7.1W	96	101	102	106	106	111	114
1 2 3 1500	10.8W	11.6W	159	145	126	130	130	137	141
1 3 2000	13.0W	16.7W	155	158	120	124	124	131	134
1 3 2500	16.7W	20.6W	150	153	117	121	121	127	131
1 3 3000	20.7W	26.0W	145	148	112	116	116	122	125
1 3 3500	24.7W	31.0W	142	144	108	112	112	118	121
1 3 4000	29.8W	37.5W	136	139	103	107	107	113	116
1 3 5000	35.8W	-	144	147	-	-	-	-	-
6000	-	-	-	-	-	-	-	-	-



## Fiche d'Installation Installation Manual

### STEP 1

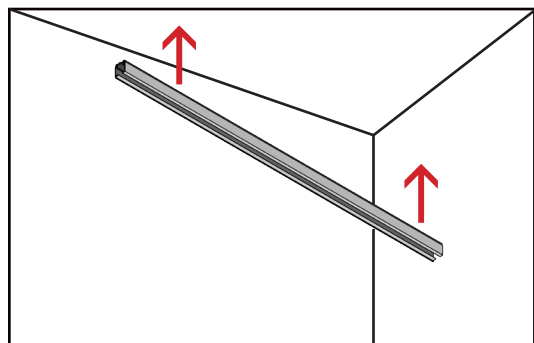

Pose du rail au plafond

Installation of the track on the ceiling

### STEP 3

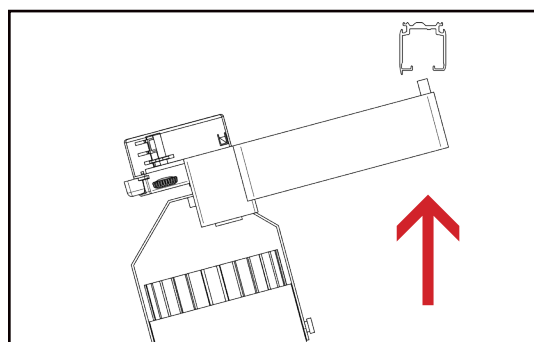

Insérez uniquement l'arrière du spot dans le rail.

Insert only the back of the spot in the rail

### STEP 5

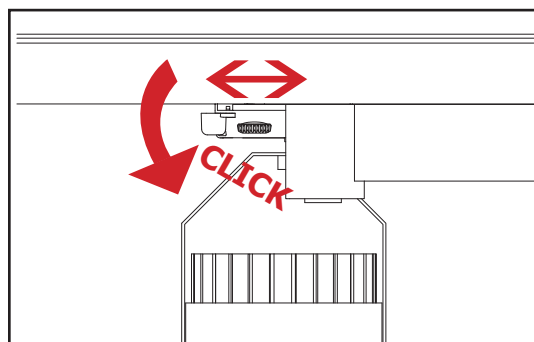

Enclencher selecteur avant (Click) & sélectionnez la phase correspondante

Switch on the front selector (Click) & select the corresponding phase

# Zora LED

### STEP 2

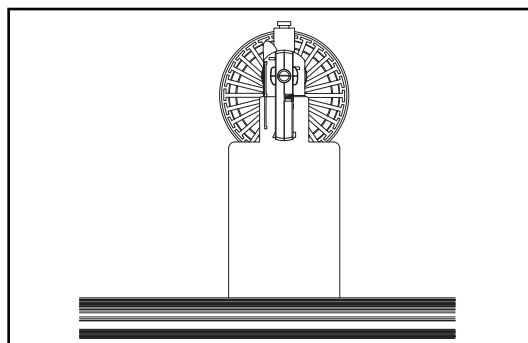

Placez le spot à un angle de 90° par rapport au rail

Keep the fixture at an angle of 90° to the rail

### STEP 4

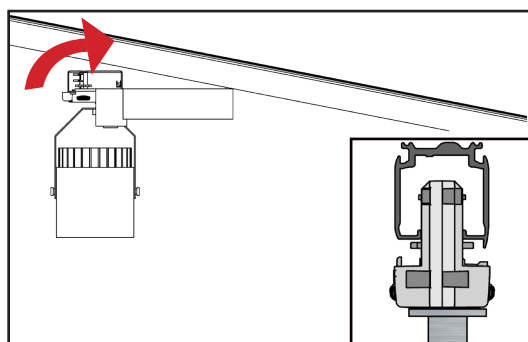

Tourner le spot dans le même direction que le rail tout en gardant les 2 ergots opposés

Turn the spot in the same direction as the rail while keeping the 2 pins opposite each other

### STEP 6

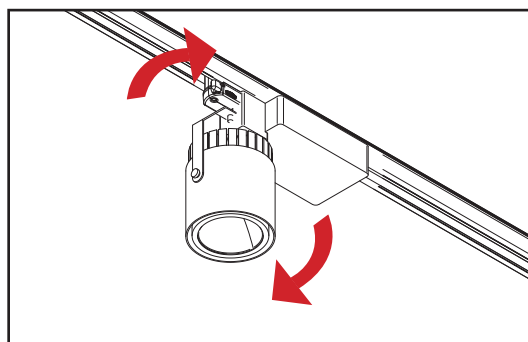

Orientez le spot dans la direction choisie.

Point the spotlight in the chosen direction



Zora LED

Nid d'abeille  
Honeycomb

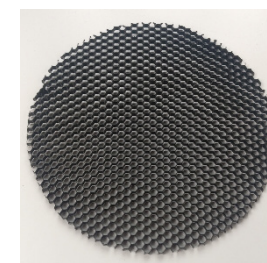

Filtre UV  
UV filter



Fixpoint



Technique de Gradation  
Dimming Technology



CASAMBI

LED couleur / Colour LED

