

Fiche Technique

Lara LED

☐ Blanc
 ☐ Noir
 ☐ Gris
 ☐ Chrom
 ☐ RAL



Caractéristiques:

Taille de découpe	N/A
Min. hauteur encastrée	N/A
Poids	1.4kg
IP	20
Classe d'isolation	II
Essai du fil incandescent	850 °C
RoHS	Oui
Sans UV	Oui
Certification	CE

Source de lumière:

Température de couleur	2700K - 3000K - 3500K - 4000K & PW
CRI	Ra 80 & Ra 90
Refroidissement	Actif & Passif
Efficience	92%
SDCM	<3
Durée de vie	50.000h
LB valeur	L90B10

Alimentation:

Driver	Inclus
Voltage	230V
Max. puissance	51.5W

Options:

Barndoors	Non
Nid d'abeille	Oui
Filtre UV	Oui
LED couleur	Oui
Dimmable	1 DALI & 2 Phase & 3 Casambi
Eclairage de secours	Non
Fixpoint	Oui

Reflectors:

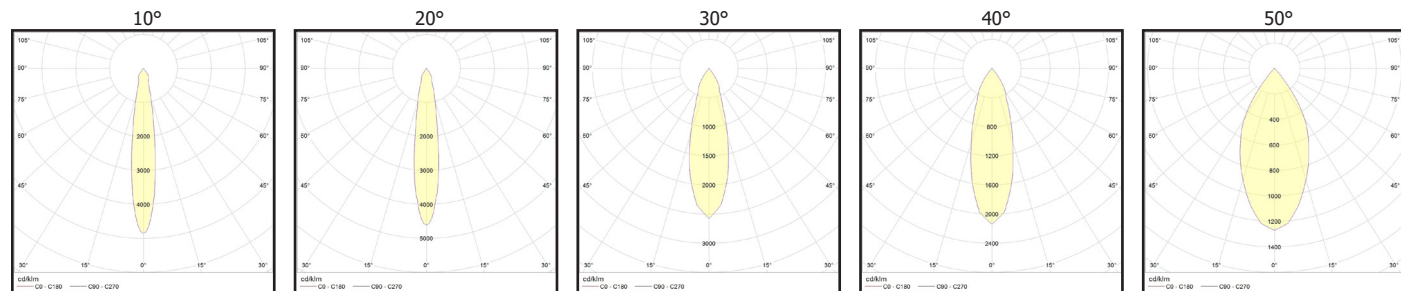
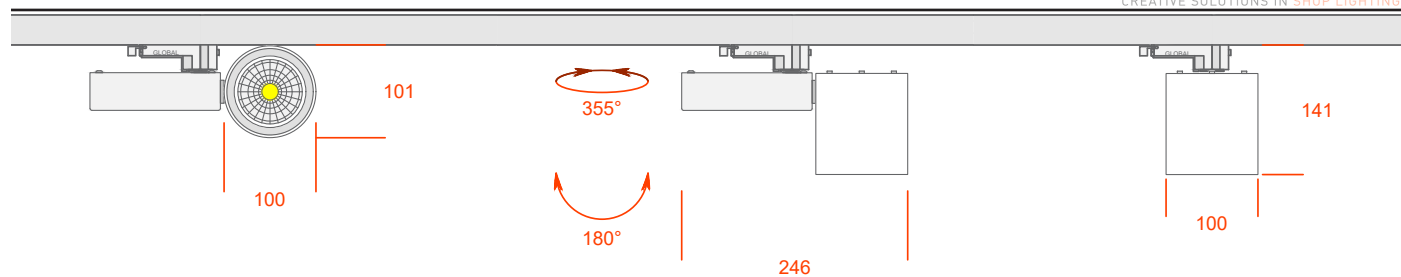
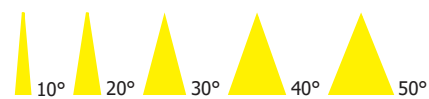

	Ra 80	Ra 90	830	835	927	930	930PW	935PW	940PW
Lumen	700	1500	2000	2500	3000	3500	4000	5000	6000
Power (W)	7.2W	10.8W	13.0W	16.7W	20.6W	24.7W	29.8W	35.8W	46.2W
Power (W)	7.1W	11.6W	16.7W	20.6W	26.0W	31.0W	37.5W	46.2W	51.5W
Lumen/Watt	96	159	155	150	145	142	136	144	136
Lumen/Watt	101	145	158	153	148	144	139	147	139
Lumen/Watt	102	126	120	117	112	108	103	110	108
Lumen/Watt	106	130	124	121	116	112	107	115	113
Lumen/Watt	106	137	124	121	116	112	107	115	113
Lumen/Watt	111	137	131	127	122	118	113	120	117
Lumen/Watt	114	141	134	131	125	121	116	124	121

Data Sheet

Lara LED

☐ White
 ☐ Black
 ☐ Grey
 ☐ Chrome
 ☐ RAL



Characteristics:

Cut-out size	N/A
Min. recessed height	N/A
Weight	1.4kg
IP	20
Isolation class	II
Glow wire test	850 °C
RoHS	Yes
UV free	Yes
Certification	CE

Light source:

Colour temperature	2700K - 3000K - 3500K - 4000K & PW
CRI	Ra 80 & Ra 90
Cooling	Actif & Passif
Efficiency	92%
SDCM	<3
Lifetime	50.000h
LB value	L90B10

Power supply:

Driver	Included
Voltage	230V
Max. power	51.5W

Reflectors:

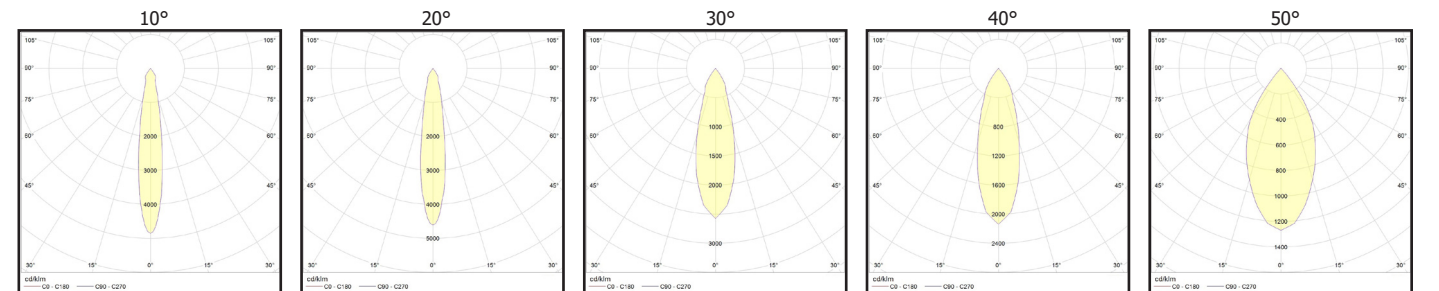
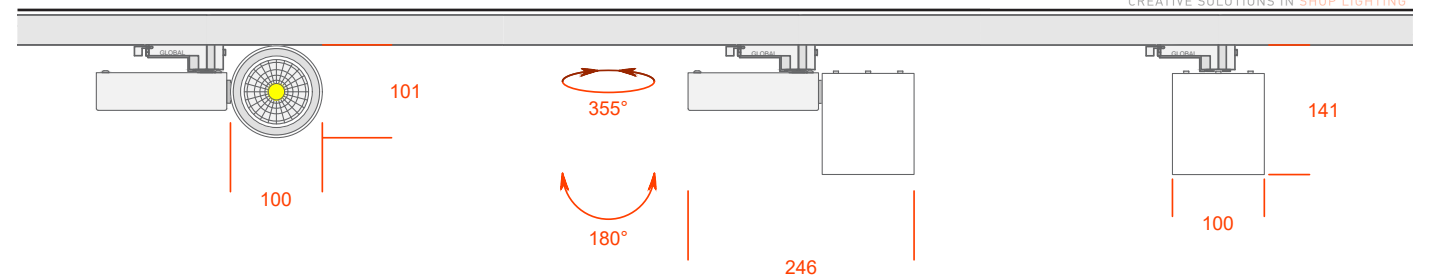
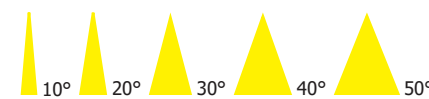

	Ra 80	Ra 90	830	835	927	930	930PW	935PW	940PW
Lumen	700	1500	2000	2500	3000	3500	4000	5000	6000
Power (W)	7.2W	10.8W	13.0W	16.7W	20.6W	24.7W	29.8W	35.8W	46.2W
Power (W)	7.1W	11.6W	16.7W	20.6W	26.0W	31.0W	37.5W	46.2W	51.5W
Lumen/Watt	96	159	155	150	145	142	136	144	136
Lumen/Watt	101	145	158	153	148	144	139	147	139
Lumen/Watt	102	126	120	117	112	108	103	110	108
Lumen/Watt	106	130	124	121	116	112	107	115	113
Lumen/Watt	106	137	124	121	116	112	107	115	113
Lumen/Watt	111	137	131	127	122	118	113	120	117
Lumen/Watt	114	141	134	131	125	121	116	124	121



Fiche d'Installation Installation Manual

STEP 1

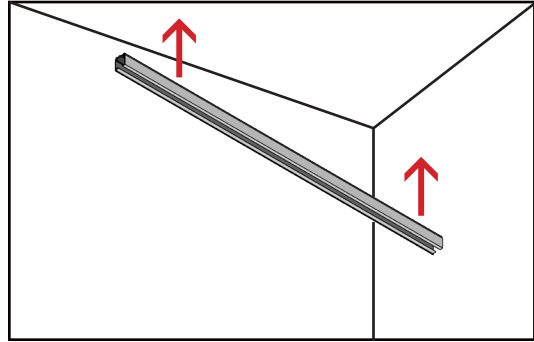

Pose du rail au plafond

Installation of the track on the ceiling

STEP 3

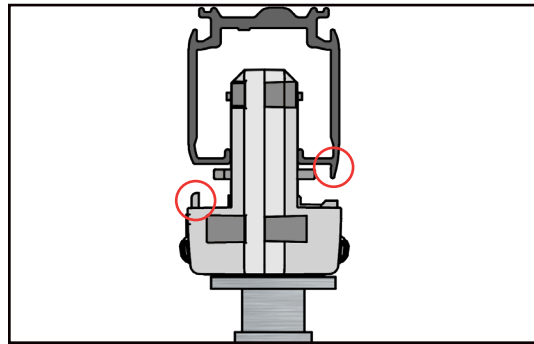

Mettre les 2 ergots à l'opposé l'un de l'autre

Put the 2 pins opposite each other

STEP 5

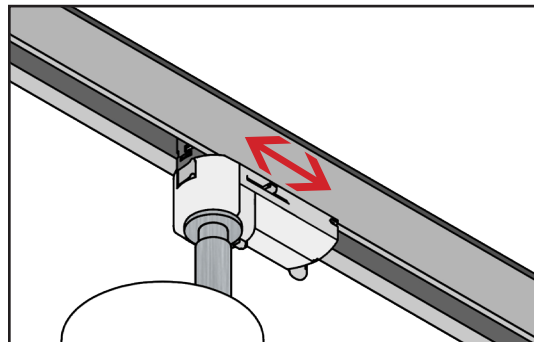

Sélectionnez la phase correspondante

Select the corresponding phase

STEP 2

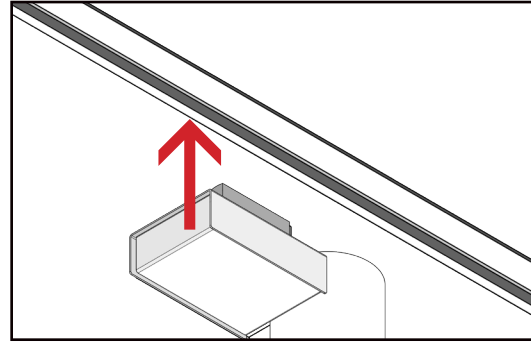

Inserer le spot dans le rail

Insert the spotlight into the track

STEP 4

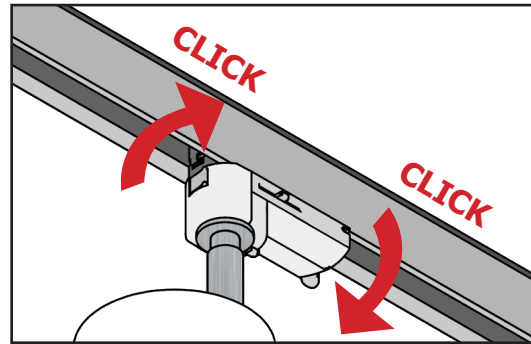

Enclencher le selecteur + verouillage avant (Click)

Switch on the selector + front locking (Click)

STEP 6

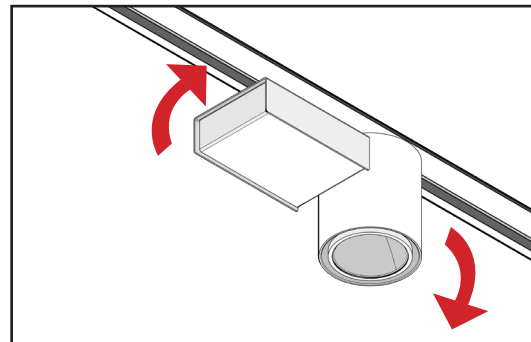

Orientez le spot dans la direction choisie.

Point the spotlight in the chosen direction

Lara LED



Lara LED

Barndoor

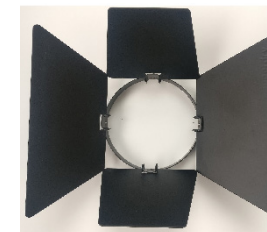

Nid d'abeille
Honeycomb

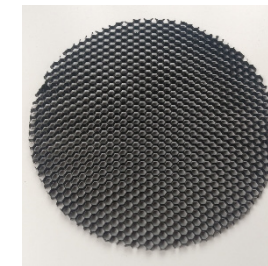

Filtre UV
UV filter



Fixpoint



Technique de Gradation
Dimming Technology



LED couleur / Colour LED

