

Fiche Technique

Free Tora LED

Blanc Noir Gris Chroom RAL



Caractéristiques:

Taille de découpe	N/A
Min. hauteur encastrée	N/A
Poids	1.95kg
IP	20
Classe d'isolation	II
Essai du fil incandescent	850 °C
RoHS	Oui
Sans UV	Oui
Certification	CE

Source de lumière:

Température de couleur	2700K - 3000K - 3500K - 4000K & PW
CRI	Ra 80 & Ra 90
Refroidissement	Actif & Passif
Efficience	92%
SDCM	<3
Durée de vie	50.000h
LB valeur	L80B10

Alimentation:

Driver	Inclus
Voltage	230V
Max. puissance	51.5W

Options:

Barndoors	Non
Nid d'abeille	Oui
Filtre UV	Oui
LED couleur	Oui
Dimmable	1 DALI & 2 Phase& 3 Casambi
Eclairage de secours	Non
Fixpoint	Oui
Lumière alternative	G53 - AR111
Puissance lampe	10W - 15W

Reflectors:

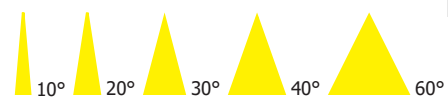

Projection.eu
CREATIVE SOLUTIONS IN SHOP LIGHTING

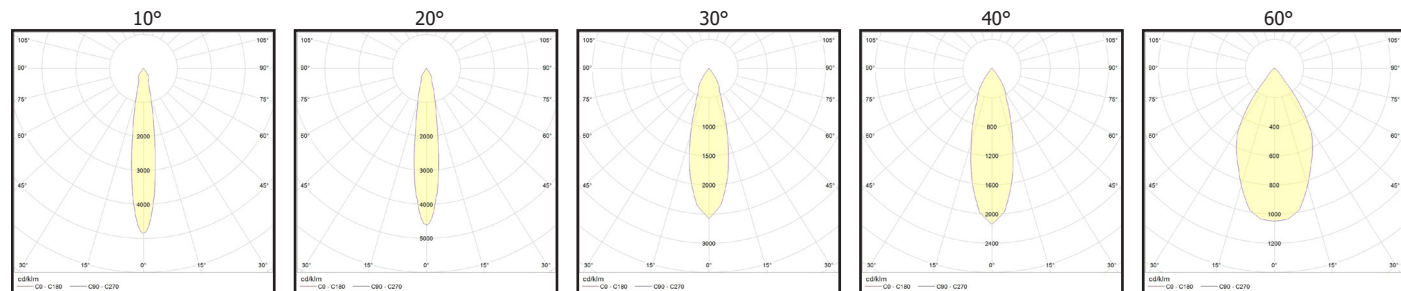
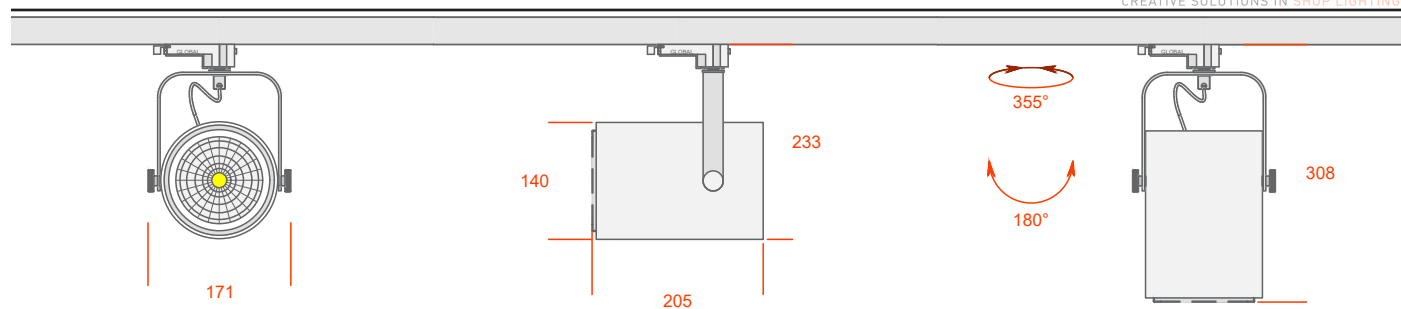

	Ra 80	Ra 90	830	835	927	930	930PW	935PW	940PW
Lumen	Power (W)	Power (W)	Lumen/Watt	Lumen/Watt	Lumen/Watt	Lumen/Watt	Lumen/Watt	Lumen/Watt	Lumen/Watt
1 2 3 700	7.2W	7.1W	96	101	102	106	106	111	114
1 2 3 1500	10.8W	11.6W	159	145	126	130	130	137	141
1 3 2000	13.0W	16.7W	155	158	120	124	124	131	134
1 3 2500	16.7W	20.6W	150	153	117	121	121	127	131
1 3 3000	20.7W	26.0W	145	148	112	116	116	122	125
1 3 3500	24.7W	31.0W	142	144	108	112	112	118	121
1 3 4000	29.8W	37.5W	136	139	103	107	107	113	116
1 3 5000	35.8W	46.2W	144	147	110	115	115	120	124
1 3 6000	46.2W	51.5W	136	139	108	113	113	117	121

Data Sheet

Free Tora LED

White Black Grey Chrome RAL



Characteristics:

Cut-out size	N/A
Min. recessed height	N/A
Weight	1.95kg
IP	20
Isolation class	II
Glow wire test	850 °C
RoHS	Yes
UV free	Yes
Certification	CE

Light source:

Colour temperature	2700K - 3000K - 3500K - 4000K & PW
CRI	Ra 80 & Ra 90
Cooling	Actif & Passif
Efficience	92%
SDCM	<3
Lifetime	50.000h
LB value	L80B10

Power supply:

Driver	Included
Voltage	230V
Max. power	51.5W

Options:

Barndoors	No
Honeycomb	Yes
UV filter	Yes
Colour LED	Yes
Dimmable	1 DALI & 2 Phase& 3 Casambi
Emergency light	No
Fixpoint	Yes
Alternative light source	G53 - AR111
Power lamp	10W - 15W

Reflectors:

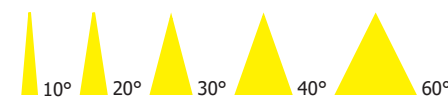

Projection.eu
CREATIVE SOLUTIONS IN SHOP LIGHTING

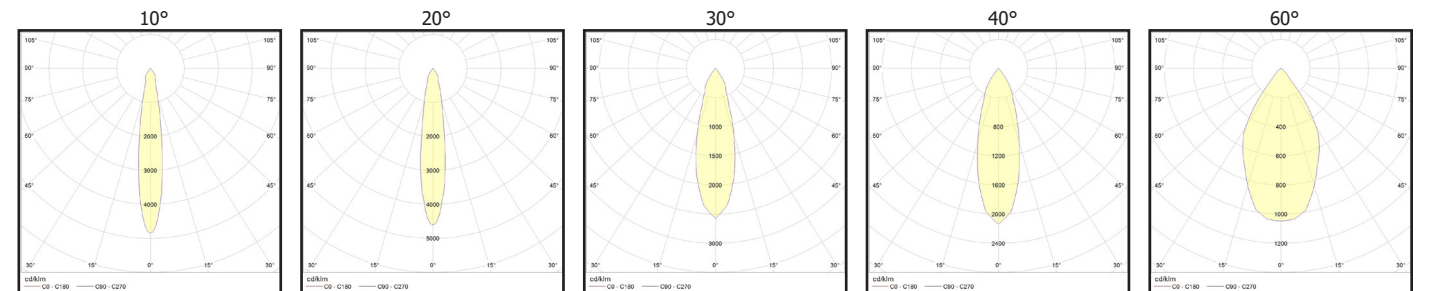
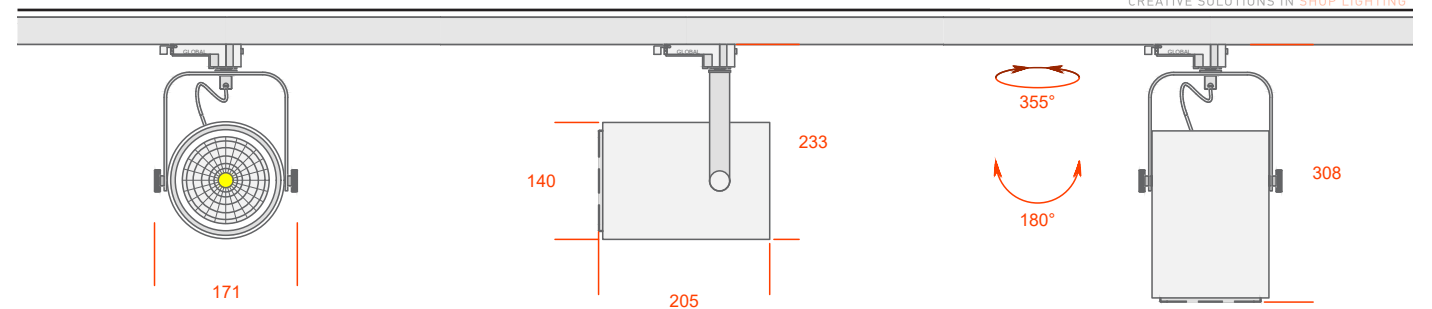

	Ra 80	Ra 90	830	835	927	930	930PW	935PW	940PW
Lumen	Power (W)	Power (W)	Lumen/Watt	Lumen/Watt	Lumen/Watt	Lumen/Watt	Lumen/Watt	Lumen/Watt	Lumen/Watt
1 2 3 700	7.2W	7.1W	96	101	102	106	106	111	114
1 2 3 1500	10.8W	11.6W	159	145	126	130	130	137	141
1 3 2000	13.0W	16.7W	155	158	120	124	124	131	134
1 3 2500	16.7W	20.6W	150	153	117	121	121	127	131
1 3 3000	20.7W	26.0W	145	148	112	116	116	122	125
1 3 3500	24.7W	31.0W	142	144	108	112	112	118	121
1 3 4000	29.8W	37.5W	136	139	103	107	107	113	116
1 3 5000	35.8W	46.2W	144	147	110	115	115	120	124
1 3 6000	46.2W	51.5W	136	139	108	113	113	117	121



Fiche d'Installation Installation Manual

STEP 1

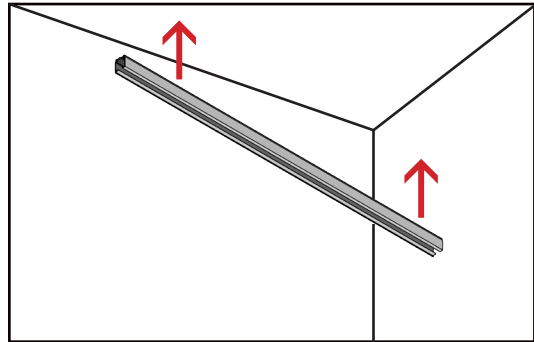

Pose du rail au plafond

Installation of the track on the ceiling

STEP 3

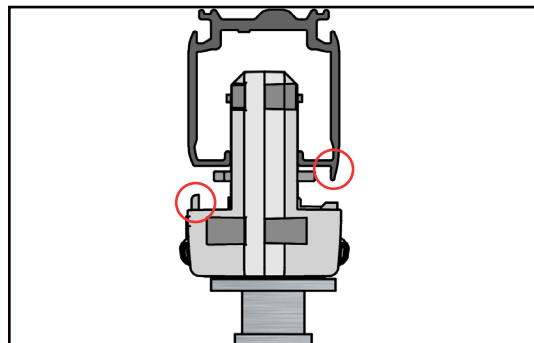

Mettre les 2 ergots à l'opposé l'un de l'autre

Put the 2 pins opposite each other

STEP 5

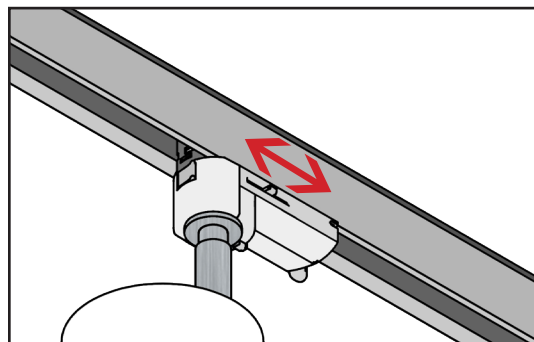

Sélectionnez la phase correspondante

Select the corresponding phase

STEP 2

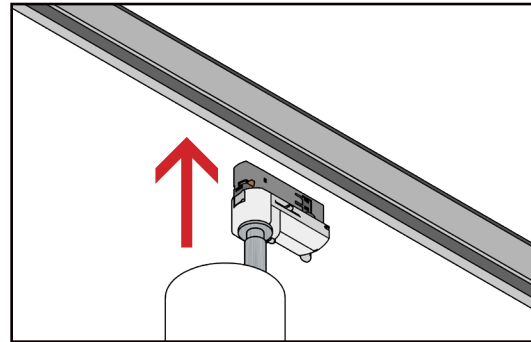

Inserer le spot dans le rail

Insert the spotlight into the track

STEP 4

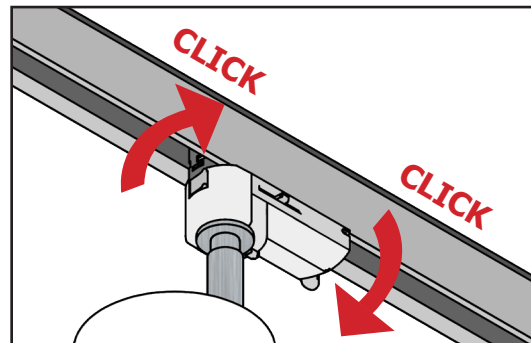

Enclencher le selecteur + verouillage avant (Click)

Switch on the selector + front locking (Click)

STEP 6

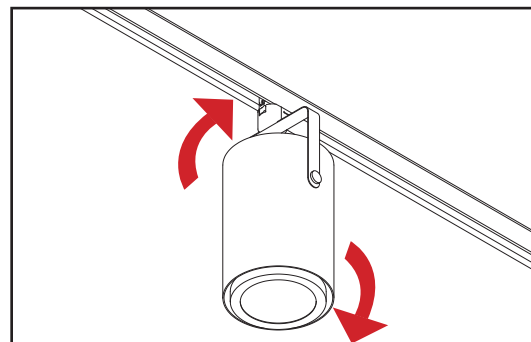

Orientez le spot dans la direction choisie.

Point the spotlight in the chosen direction

Free Tora LED



Free Tora LED

Nid d'abeille
Honeycomb

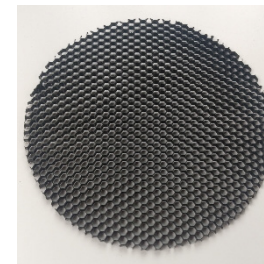

Filtre UV
UV filter



Fixpoint



Lampe AR111
AR111 lamp



Technique de Gradation
Dimming Technology



CASAMBI

LED couleur / Colour LED

