

Fiche Technique

Baya LED

☐ Blanc
 ☐ Noir
 ☐ Gris
 ☐ Chroom
 ☐ RAL



Caractéristiques:

Taille de découpe	N/A
Min. hauteur encastrée	N/A
Poids	1.5kg
IP	20
Classe d'isolation	II
Essai du fil incandescent	850 °C
RoHS	Oui
Sans UV	Oui
Certification	CE

Source de lumière:

Température de couleur	2700K - 3000K -
	3500K - 4000K & PW
CRI	Ra 80 & Ra 90
Refroidissement	Actif & Passif
Efficience	92%
SDCM	<3
Durée de vie	50.000h
LB valeur	L80B10

Alimentation:

Driver	Inclus
Voltage	230V
Max. puissance	31W

Options:

Barndoors	Non
Nid d'abeille	Oui
Filtre UV	Oui
LED couleur	Oui
Dimmable	1 DALI & 2 Phase & 3 Casambi
Eclairage de secours	Non
Fixpoint	Oui

Reflectors:

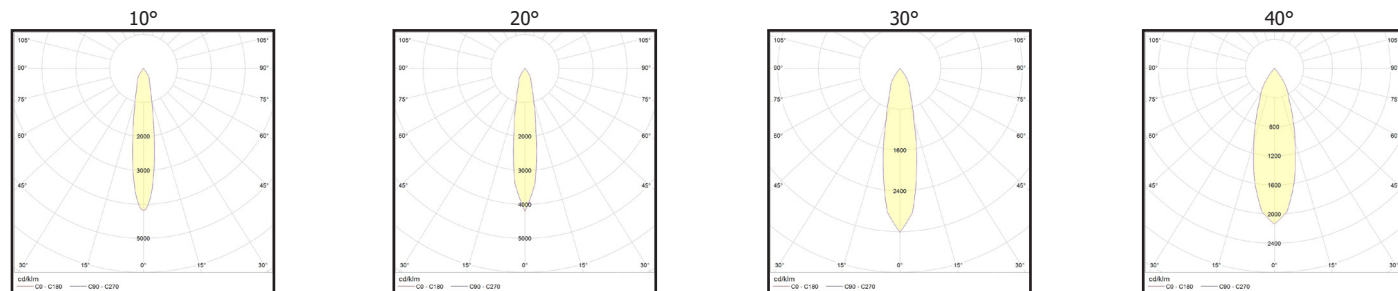
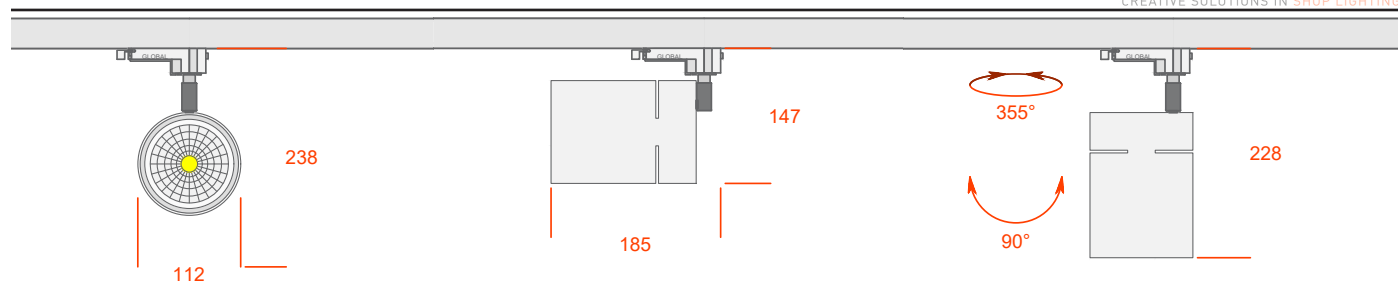

	Ra 80	Ra 90	830	835	927	930	930PW	935PW	940PW
Lumen	Power (W)	Power (W)	Lumen/Watt	Lumen/Watt	Lumen/Watt	Lumen/Watt	Lumen/Watt	Lumen/Watt	Lumen/Watt
123 700	7.2W	7.1W	96	101	102	106	106	111	114
123 1500	10.8W	11.6W	159	145	126	130	130	137	141
2000	13.0W	16.7W	155	158	120	124	124	131	134
2500	16.7W	20.6W	150	153	117	121	121	127	131
3000	20.7W	26.0W	145	148	112	116	116	122	125
3500	24.7W	31.0W	142	144	108	112	112	118	121
4000	29.8W	-	136	139	-	-	-	-	-
5000	-	-	-	-	-	-	-	-	-
6000	-	-	-	-	-	-	-	-	-

Data Sheet

Baya LED

☐ White
 ☐ Black
 ☐ Grey
 ☐ Chrome
 ☐ RAL



Characteristics:

Cut-out size	N/A
Min. recessed height	N/A
Weight	1.5kg
IP	20
Isolation class	II
Glow wire test	850 °C
RoHS	Yes
UV free	Yes
Certification	CE

Light source:

Colour temperature	2700K - 3000K -
	3500K - 4000K & PW
CRI	Ra 80 & Ra 90
Cooling	Actif & Passif
Efficiency	92%
SDCM	<3
Lifetime	50.000h
LB value	L80B10

Power supply:

Driver	Included
Voltage	230V
Max. power	31W

Reflectors:

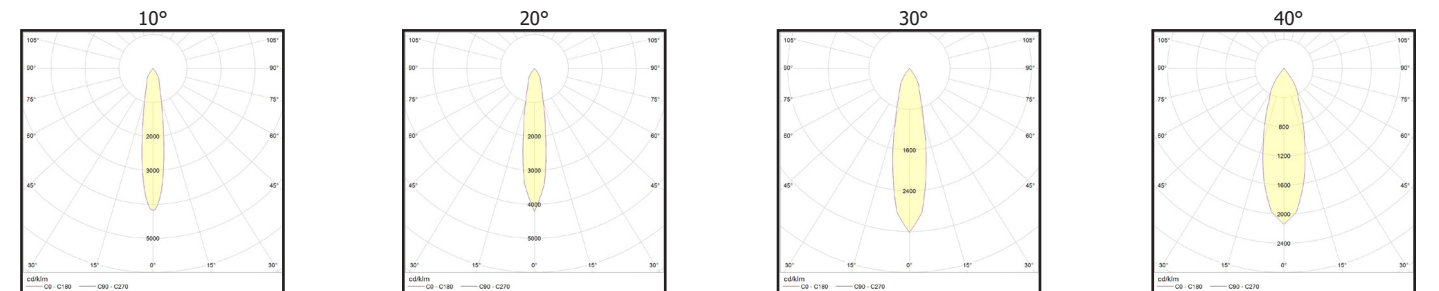
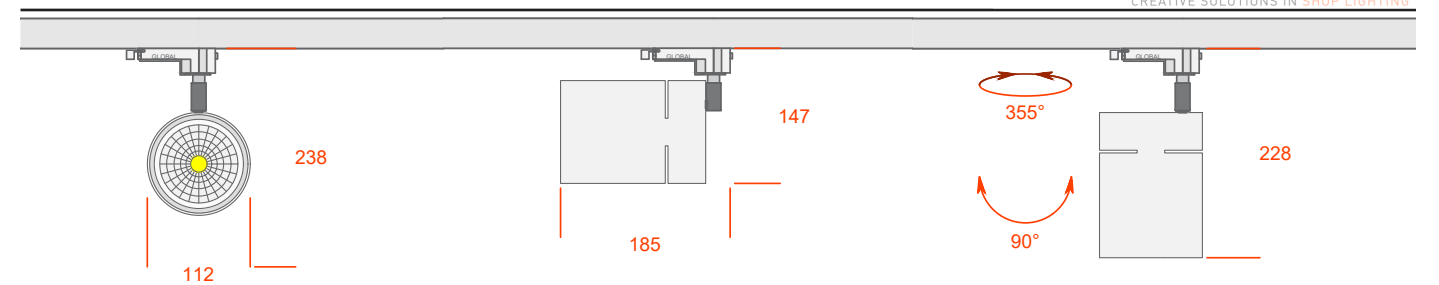
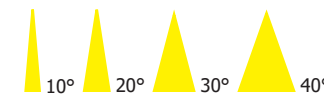

	Ra 80	Ra 90	830	835	927	930	930PW	935PW	940PW
Lumen	Power (W)	Power (W)	Lumen/Watt	Lumen/Watt	Lumen/Watt	Lumen/Watt	Lumen/Watt	Lumen/Watt	Lumen/Watt
123 700	7.2W	7.1W	96	101	102	106	106	111	114
123 1500	10.8W	11.6W	159	145	126	130	130	137	141
2000	13.0W	16.7W	155	158	120	124	124	131	134
2500	16.7W	20.6W	150	153	117	121	121	127	131
3000	20.7W	26.0W	145	148	112	116	116	122	125
3500	24.7W	31.0W	142	144	108	112	112	118	121
4000	29.8W	-	136	139	-	-	-	-	-
5000	-	-	-	-	-	-	-	-	-
6000	-	-	-	-	-	-	-	-	-



Fiche d'Installation Installation Manual

STEP 1

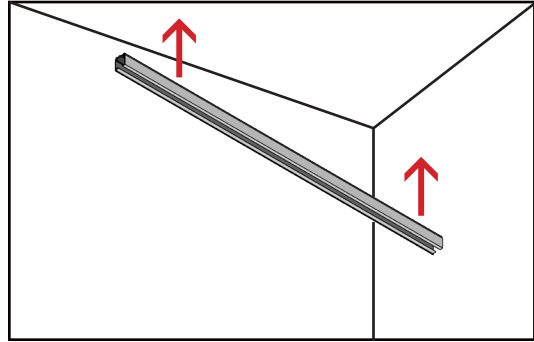

Pose du rail au plafond

Installation of the track on the ceiling

STEP 3

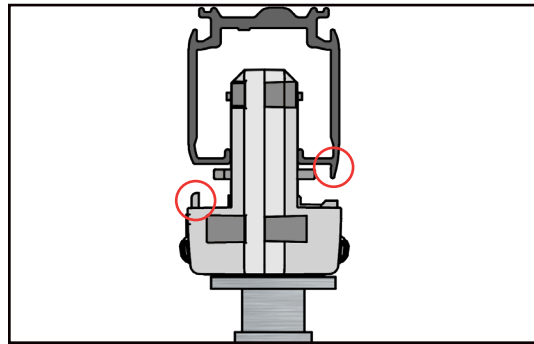

Mettre les 2 ergots a l'opposé l'un de l'autre

Put the 2 pins opposite each other

STEP 5

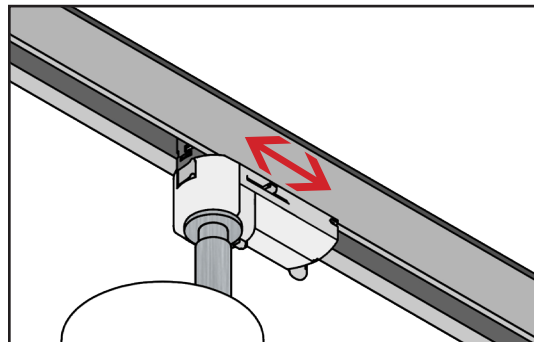

Selectionnez la phase correspondante

Select the corresponding phase

STEP 2

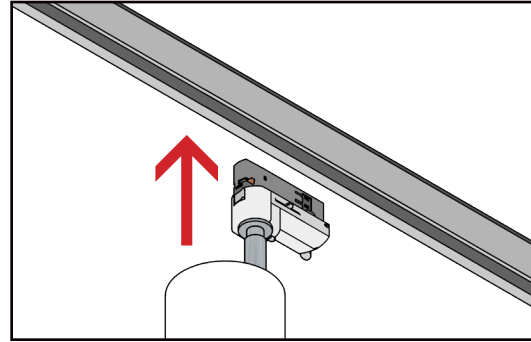

Inserer le spot dans le rail

Insert the spotlight into the track

STEP 4

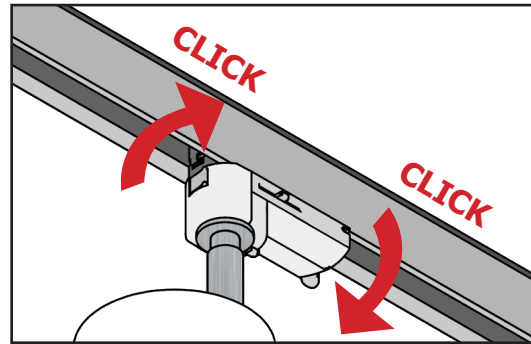

Enclencher le selecteur + verouillage avant (Click)

Switch on the selector + front locking (Click)

STEP 6

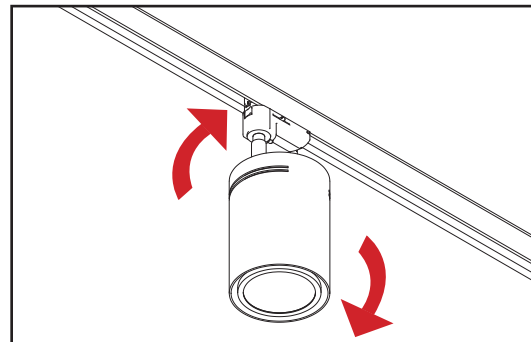

Orientez le spot dans la direction choisie.

Point the spotlight in the chosen direction

Baya LED



Baya LED

Nid d'abeille
Honeycomb

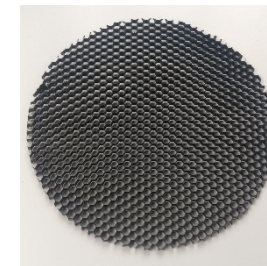

Filtre UV
UV filter



Fixpoint



Technique de Gradation
Dimming Technology



CASAMBI

LED couleur / Colour LED

